



zogics | LOCKERS

PRODUCT BROCHURE



ZOGICS LOCKERS

Our locker selection is modern, durable, and design-forward.

Meet your members' needs with a range of tiered locker configurations. Ensure your locker room is outfitted with the best lockers and locker room accessories. Choose from different sizes, different configurations, and finishes.

All locker frames are shipped whole and ready for no-hassle on-site installation.

Custom locker systems for fitness centers & athletic teams



CLUB LOCKERS

Closed door lockers in a variety of tier configurations, styles, & finishes

IMPACT Club Lockers >

Laminate Club Lockers >

Phenolic Club Lockers >

Glass Club Lockers >

Wood Club Lockers >

TEAM LOCKERS

Seated lockers with storage & secured cubbies for athletic teams

Laminate Team Lockers >

Phenolic Team Lockers >

Wood Team Lockers >

 *Click the links above to jump to a section*

CLUB LOCKERS

Our Club Locker Systems are perfect for any size fitness facility, whether you're a small studio or a large complex.

Offered in 9-tier configurations, these versatile units are available in a variety of finishes and can be outfitted with the best in locker room accessories.



9 Tier
Configurations



Quickest Lead Time &
Easiest Quoting



Full Design Staff
for Layout



Premium Finishes
& Colors



Industry Leading
Warranties



IMPACT

Club Lockers

Versatile & economical



Laminate

Club Lockers

Widest variety of colors



Phenolic

Club Lockers

Most durable & waterproof

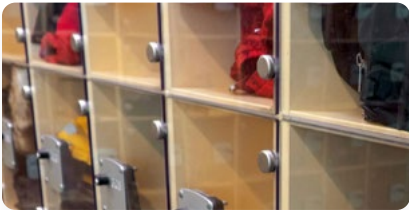

Glass

Club Lockers

Modern aesthetic



Wood

Club Lockers

Luxurious & high-end

CLUB LOCKERS

IMPACT Club Lockers

Versatile & economical locker systems in a full range of finishes and configurations

[VIEW PRODUCT](#)



FEATURES

- Premium finishes with custom matching edgebands
- 4 interior color options (Gray, White, Black, Almond)
- 4 standard lock options
- 9 tier configurations
- Made in the USA
- Ships fully assembled

SPECIFICATIONS

- **Height***: 60", 72" (standard), 84"
- **Width***: 12", 15" (standard), 18"
- **Depth***: 12", 15", 18", 20" (standard)
- **Locks**: High Security Hasp, Ojmar Combi Pro, Ojmar OCS Pro Digital, Ojmar NEXO NLX1

*Custom sizes available

MARKET APPLICATIONS

- Fitness Facilities
- Health Clubs
- Locker Rooms
- Hospitals
- Educational Facilities

Featured Premium Finishes

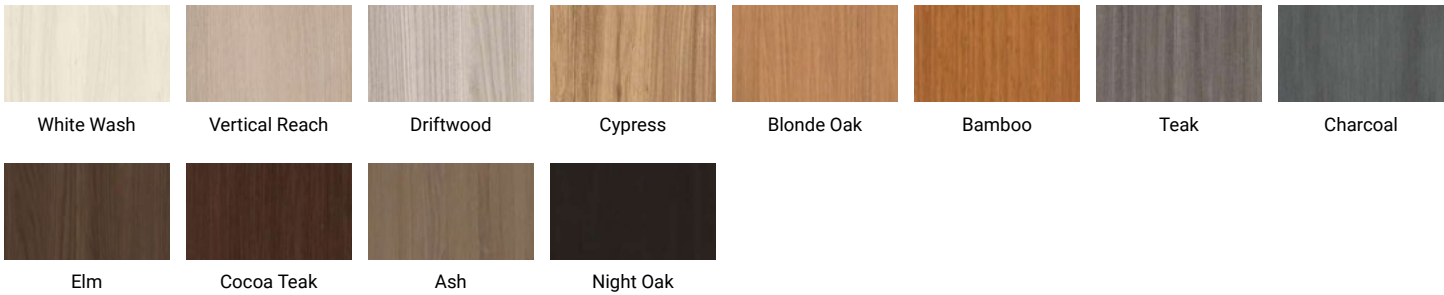

CLUB LOCKERS

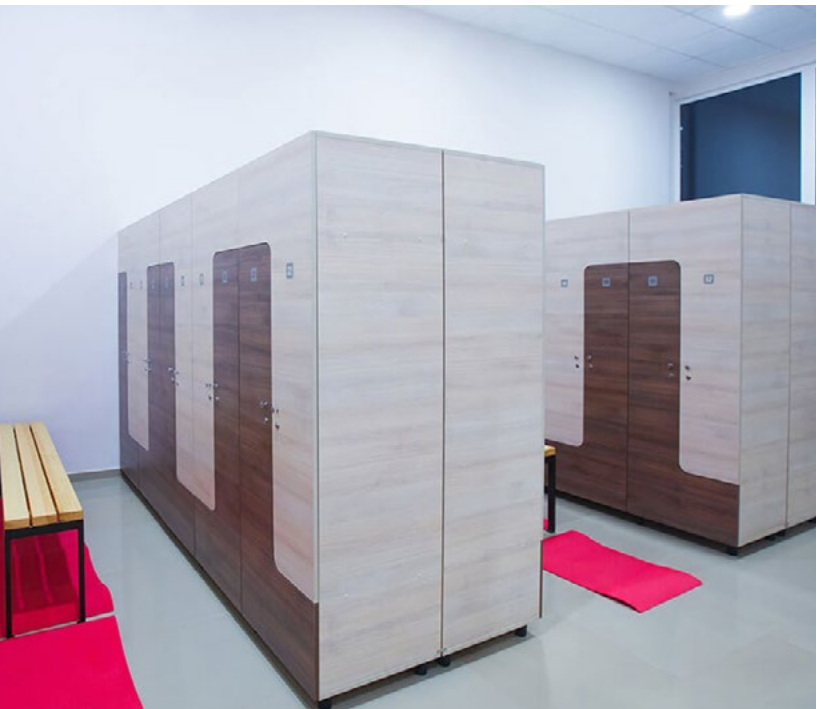

IMPACT Club Lockers

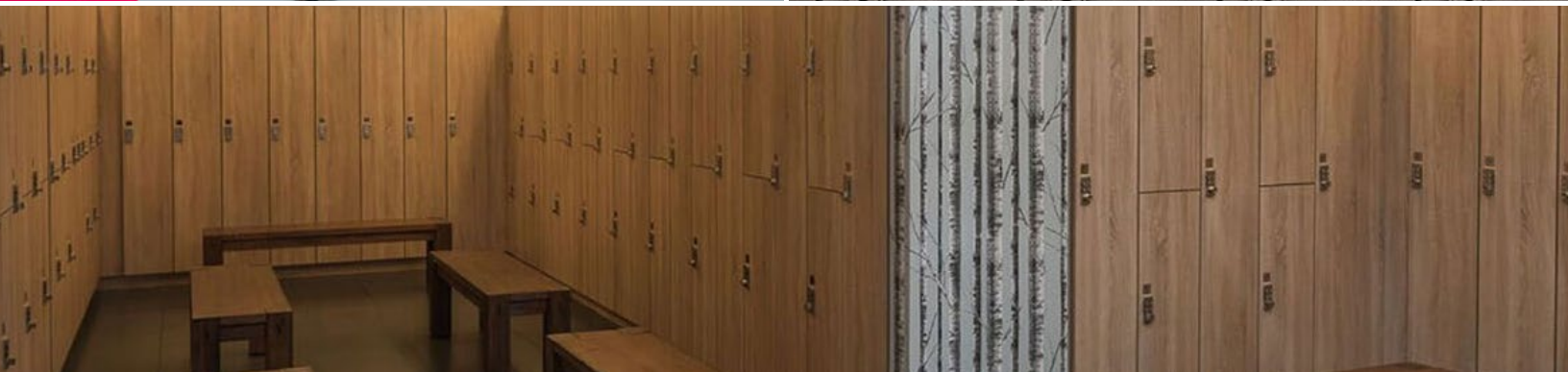

CLUB LOCKERS

Laminate Club Lockers

Our most brandable locker system with a ton of color options

[VIEW PRODUCT](#)



FEATURES

- Choose from our standard textured and smooth colors or any Wilsonart or Formica laminate option
- Laminate or Polycore locker body options
- 9 configurations
- Thermally-fused edgeband
- Include soft-close lifetime warranted hinges & interior cell/wallet shelf
- High quality surface for easy maintenance
- Made in the USA

SPECIFICATIONS

- **Height*:** 60", 72" (standard), 84"
- **Width*:** 12", 15" (standard), 18"
- **Depth*:** 12", 15", 18", 20" (standard)
- **Toe Kick:** 4"
- **Valance:** 4"
- **Locks:** High Security Hasp, Ojmar Combi Pro, Ojmar OCS Pro Digital, Ojmar NEXO NLX1

*Custom sizes available

MARKET APPLICATIONS

- Fitness Facilities
- Community Centers
- Health Clubs
- Locker Rooms
- Educational Facilities

Featured Premium Finishes



White



French Gray



Steel



Storm



Sun



Blue



Vertical Reach



Driftwood



Cypress



Blonde Oak



Bamboo



Teak



Charcoal



Elm



Cocoa Teak



Ash



Night Oak

CLUB LOCKERS

Laminate Club Lockers



Phenolic Club Lockers

Our most durable, waterproof lockers perfect for high traffic facilities

[VIEW PRODUCT](#)



FEATURES

- Waterproof to withstand extreme moisture
- Highly durable and resistant to graffiti, scratches, & impact
- 9 configurations
- Seamless edges, no edge-banding
- Include soft-close lifetime warranted hinges & interior cell/wallet shelf
- Made in the USA
- Ships fully assembled

SPECIFICATIONS

- **Height***: 60", 72" (standard), 84"
- **Width***: 12", 15" (standard), 18"
- **Depth***: 12", 15", 18", 20" (standard)
- **Toe Kick**: 4"
- **Valance**: 4"
- **Locks**: High Security Hasp, Ojmar Combi Pro, Ojmar OCS Pro Digital, Ojmar NEXO NLX1

*Custom sizes available

MARKET APPLICATIONS

- Recreational Centers
- Aquatic Centers
- Fitness Facilities
- Athletic Field Houses
- Health Clubs
- Locker Rooms

Featured Premium Finishes

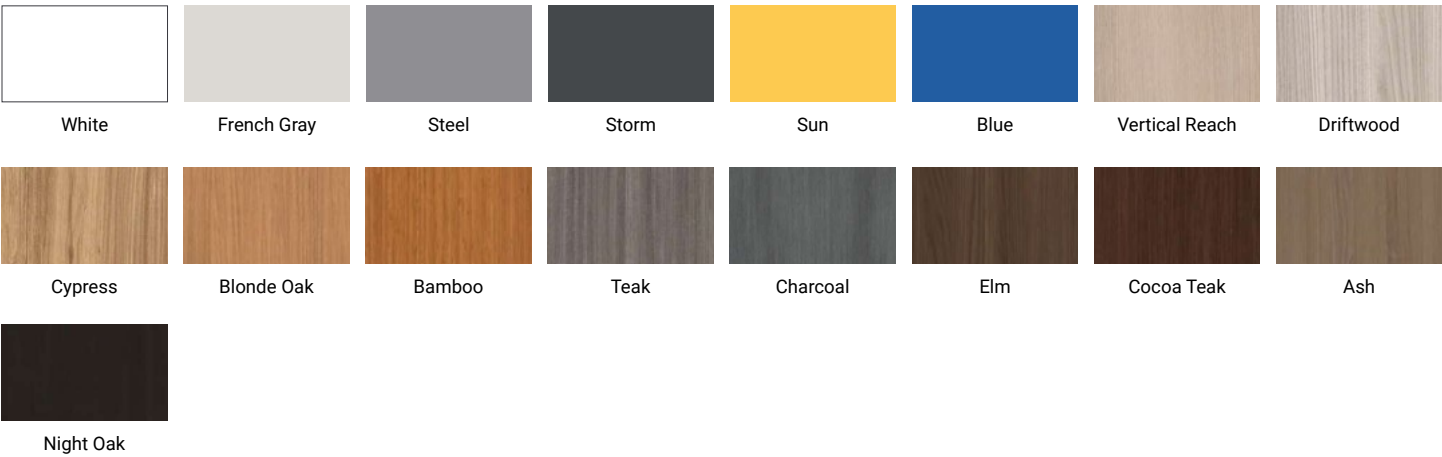

CLUB LOCKERS

Phenolic Club Lockers



CLUB LOCKERS

Glass Club Lockers

High durability and modern design for the newest trends on the market

[VIEW PRODUCT](#)



FEATURES

- 1/4" tempered shatterproof glass front
- Highly durable and resistant to moisture, shock, impact, & pressure
- 9 configurations
- Laminate or Polycore body options
- High quality solid glass surface helps prevent bacteria build up; easy to maintain
- Made in the USA
- Ships fully assembled

SPECIFICATIONS

- **Height*:** 60", 72" (standard), 84"
- **Width*:** 12", 15" (standard), 18"
- **Depth*:** 12", 15", 18", 20" (standard)
- **Toe Kick:** 4"
- **Valance:** 4"
- **Locks:** High Security Hasp, Ojmar Combi Pro, Ojmar OCS Pro Digital, Ojmar NEXO NLX1

*Custom sizes available

MARKET APPLICATIONS

- Recreational Centers
- Aquatic Centers
- Fitness Facilities
- Athletic Field Houses
- Health Clubs
- Locker Rooms

Featured Premium Finishes



White



Black



Cool Gray



Slate



Slate



Mint

CLUB LOCKERS



Glass Club Lockers



CLUB LOCKERS

Wood Club Lockers

Luxury wood finishes for a high end look

[VIEW PRODUCT](#)



FEATURES

- Luxurious wood lockers in a variety of styles & stains
- Built with an interior mini-shelf, interior ventilation, & soft-close hinges
- 9 configurations
- Laminate or Polycore body options
- Thermally-fused matching edgeband built to stay on for life
- Made in the USA
- Ships fully assembled

SPECIFICATIONS

- **Height***: 60", 72" (standard), 84"
- **Width***: 12", 15" (standard), 18"
- **Depth***: 12", 15", 18", 20" (standard)
- **Toe Kick**: 4"
- **Valance**: 4"
- **Door Styles**: Slab, Shaker, Raised Panel, Flat Panel, Louver, Raised Panel + Louver
- **Locks**: High Security Hasp, Ojmar Combi Pro, Ojmar OCS Pro Digital, Ojmar NEXO NLX1

*Custom sizes available

MARKET APPLICATIONS

- Country Clubs
- Spas & Salons
- High End Corporate Offices
- Health Clubs
- Locker Rooms

Featured Premium Finishes



Champagne



Natural UV

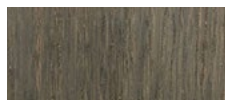

Mystic



Walnut

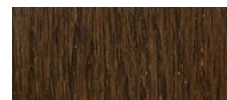

Umber



Mahogany

Door Styles

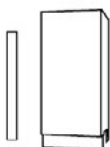

Slab

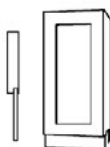

Shaker

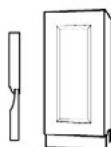

Raised Panel

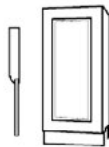

Flat Panel

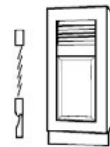

Raised Panel + Louver

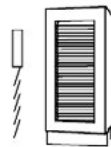

Louver

CLUB LOCKERS

Wood Club Lockers

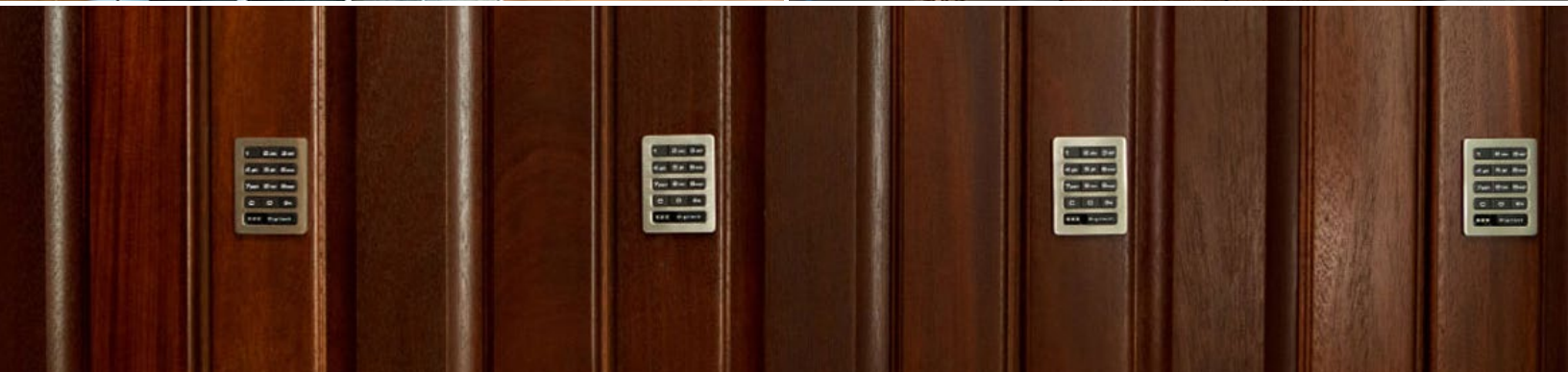

TEAM LOCKERS

Our Team Locker Systems are offered in a variety of configurations that are an exceptionally attractive and durable choice for team rooms.

Built to stand up to the demands of athletes, our team lockers are designed with customization and modularity in mind.



Designed for
Athletes



Quickest Lead Time &
Easiest Quoting



Full Design Staff
for Layout



Wide Range of Colors
& Branding Options



Industry Leading
Warranties



Laminate

Team Lockers

Versatile & economical



Phenolic

Team Lockers

Most durable & waterproof



Wood

Team Lockers

Luxurious wood finish

TEAM LOCKERS

Laminate Team Lockers

*Versatile & economical athletic lockers
with storage*

[VIEW PRODUCT](#)



FEATURES

- Designed by athletes for athletes
- Budget-friendly & economic
- Engineered with laminate solid surface to prevent bacteria buildup
- Vented design allows for quicker dry time
- Endless customization possibilities
- Made in the USA

SPECIFICATIONS

- **Height***: 76"
- **Width***: 24", 30"
- **Depth***: 24"
- **Toe Kick**: 4"
- **Locks**: High Security Hasp, Ojmar Combi Pro, Ojmar OCS Pro Digital, Ojmar NEXO NLX1

**Custom sizes available*

MARKET APPLICATIONS

- Athletic Locker Rooms
- Athletic Training Centers
- Professional & Collegiate Locker Rooms

Featured Premium Finishes



TEAM LOCKERS

Phenolic Team Lockers

Athletic lockers designed for wet & humid locker rooms

[VIEW PRODUCT](#)



FEATURES

- Built to withstand extreme moisture & high-use conditions
- Resistant to graffiti, scratches, & impact
- Phenolic construction is a non-wood, solid resin panel that will outlast the competition
- Designed by athletes for athletes
- Vented design allows for quicker dry time
- Endless customization possibilities
- Made in the USA

SPECIFICATIONS

- **Height***: 76"
- **Width***: 24", 30"
- **Depth***: 24"
- **Toe Kick**: 4"
- **Locks**: High Security Hasp, Ojmar Combi Pro, Ojmar OCS Pro Digital, Ojmar NEXO NLX1

**Custom sizes available*

MARKET APPLICATIONS

- Athletic Locker Rooms
- Athletic Training Centers
- Professional & Collegiate Locker Rooms
- High School Locker Rooms
- Aquatic Centers
- High-Moisture Areas

Featured Premium Finishes



White



French Gray



Steel



Storm



Black



Blue



White Wash



Elm



Silver Plank



Driftwood



Beigewood



Oak Natural



Teak



Elm Aged



Ash



Charcoal



Walnut



Walnut Aged

TEAM LOCKERS

Wood Team Lockers

Athletic lockers with luxurious wooden finish

[VIEW PRODUCT](#)



FEATURES

- Variety of premium wooden species & strains for a high-end look
- Expertly crafted locker systems that leave an impression
- Includes a thermally-fused, matched edge that stays on for life
- Designed by athletes for athletes
- Vented design allows for quicker dry time
- Endless customization possibilities
- Made in the USA

SPECIFICATIONS

- **Height***: 76"
- **Width***: 24", 30"
- **Depth***: 24"
- **Toe Kick**: 4"
- **Locks**: High Security Hasp, Ojmar Combi Pro, Ojmar OCS Pro Digital, Ojmar NEXO NLX1

**Custom sizes available*

MARKET APPLICATIONS

- Athletic Locker Rooms
- Athletic Training Centers
- Professional & Collegiate Locker Rooms
- High School Locker Rooms
- Aquatic Centers
- High-Moisture Areas

Featured Premium Finishes



Champagne



Natural UV



Mystic



Walnut

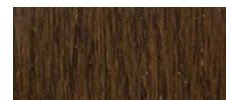

Umber



Mahogany



CELL PHONE LOCKERS



TOWEL DROPS & GROOMING STATIONS



CLUB LOCKER CONFIGURATIONS



LOCK OPTIONS



BENCHES





Cell Phone Lockers (CLC)

MAXIMIZE SPACE. MINIMIZE INVESTMENT.

Zogics Club Locker configuration CLC is built with integrated USB chargers. Our cell phone lockers feature both cell phone and laptop compartments, with a USB port in each. Your members will finish their workout with a fully charged phone.



Towel Drops & Grooming Stations

INTEGRATED AMENITY YOUR GUESTS WILL LOVE

Grooming stations and towel drops will keep your locker room clean and your members looking fresh. Towel drops complement your locker configuration.

With a pre-cut opening, installation is easy. Our grooming stations come standard with a storage cabinet, solid surface countertop, directional lighting, electrical outlets, and a mirror.

All Zogics grooming and towel drops ship fully assembled and are backed by a 3-year warranty.



CL5 (Five doors)



CL2 (Two doors)



CL1 (One door)

Club Locker Configurations

Our standard locker room configurations provides your facility with a variety of layout options.



CL1
Full height
One door



CL2
Half height
Two doors



CL3
Triple height
Three doors



CL4
Quad height
Four doors



CL5
Penta height
Five doors



CL6
Hex height
Six doors



CLZ
Split height
Two doors



CLH
Hybrid split
Two doors

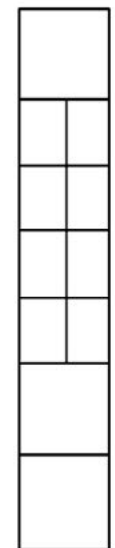

CLC
USB chargers
Eleven doors

Lock Options

Security is essential for lockers. Choose from simple yet effective padlock hasps to high-tech options such as keypads and digital touch.



HIGH SECURITY HASP

- Budget Friendly
- Battery & Wire Free
- Steel Plate Protects Finish
- Dry/Wet Use
- Color: Brushed Stainless Steel



OJMAR COMBI PRO

- Keyless 4-digit lock
- Leading keyless mechanical lock
- Waterproof
- Colors: Silver, Black, White



OJMAR OCS PRO/SMART

- Touch keypad lock
- Durable touch keypad
- Long-lasting battery
- Easy programming
- Sleek design
- Colors: Silver, Graphite, White



OJMAR NEXO NLX1

- Wireless real-time lock system
- Bluetooth & RFID operation
- Remote monitoring
- Control & data reports
- Color: Silver



Benches

Complete your locker room layout with sleek and durable benches. Select from a variety of base configurations, colors, and sizes.

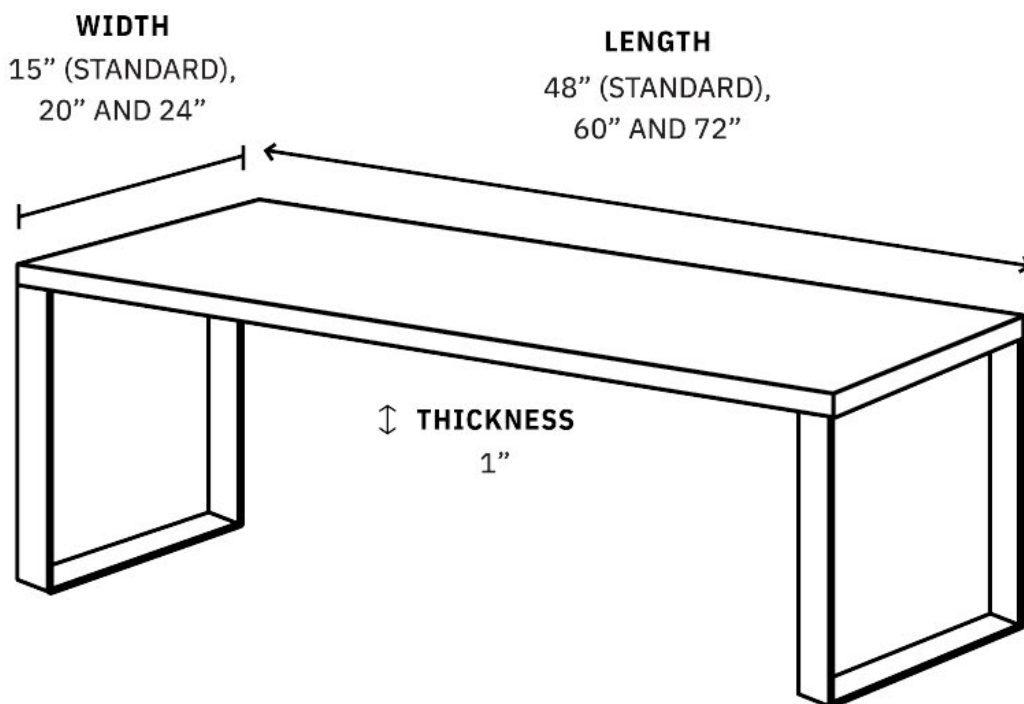

SQUARE

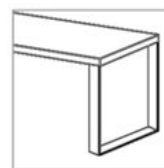

PEDESTAL



BUILT-IN

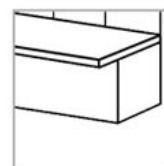



Still have questions?
We love to help!

zogics.com • hello@zogics.com • 888.623.0088