

Bissell[®]

BigGreen Commercial[™]

Hercules Vapor Scrub Steam Cleaner

Model BGST500T

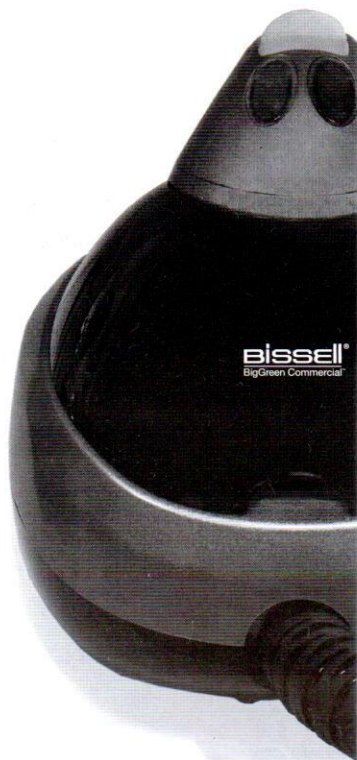

Care and Use Instructions

For service and further information, please contact:

Bissell BigGreen Commercial

100 Armstrong Road, Suite 101, Plymouth, MA 02360

Phone: 800-242-1378 Fax: 877-672-4566

www.bissellcommercial.com

Bissell®

BigGreen Commercial™

Thank you for purchasing your Hercules Vapor Scrub Steam Cleaner, we hope you enjoy using it.

Please read the manual carefully to get the most out of your product.

Pack contents:

1. Hercules Vapor Scrub Steam Cleaner -
2. Steam Cap -
3. Steam Gun -
4. Extension Wands -
5. Swivel Adaptor -
6. Jug -
- 6a. Funnel -
7. Straight Adaptor -
8. Floor Tool and Adaptor -
9. Window/Tile Cleaner -
10. Towel -
11. Angled Nozzle -
12. Round Brushes, Large and Small -

- BGST500T
ST500T-2
ST500T-3
ST500T-4
ST500T-5
ST500T-6
ST500T-6A
ST500T-7
ST500T-8
ST500T-9
ST500T-10
ST500T-11
ST500T-12

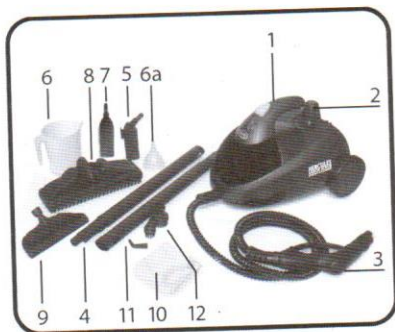

- Please note that some accessories are stored at the front of the product under the lifting section.

Read the instruction book before using the Hercules Vapor Scrub Steam Cleaner and make sure that...

- The cable is in perfect condition.
- All packaging materials are removed from the product.

Safety Instructions - CAUTION!

- Do not direct steam at people, animals or at electrical devices.
- Do not operate machine without water in the tank.
- Do not allow machine to run unattended at any time.
- Close supervision is necessary when this machine is used near children. Do not allow it to be used as a toy.
- The machine is designed for household use only, do not expose to rain.
- Do not overfill the water tank. The machine contains a maximum of 50 fl.oz (1500ml) of water only. Excessive filling of the water tank may cause damage or injury.
- Never turn the machine over or tilt more than 45° when it is switched on or producing steam.
- Use extra care when cleaning stairs or using stepladders.
- To provide continued protection against the risk of electric shock connect properly grounded outlets only.
- Use only genuine manufacturer's parts.
- It is recommended that a suitably rated GFCI/ALCI device is fitted into the mains supply socket for added protection against electric shock.
- Do not immerse cord, plug or machine in water or any other liquid.
- Do not drag or try to move boiler by pulling either the hose or the mains lead.
- Do not operate with a damaged cord, keep feet and all parts of body away from the jet of steam. Do not operate machine in bare feet or when wearing open toe shoes or sandals.
- Do not pull or carry by cord, or use cord as a handle, close door on cord or pull cord around sharp edges or corners. Keep cord away from heated surfaces.
- Unplug cleaner when not in use. Turn all controls off before unplugging from electrical outlet.
- Do not unplug by pulling on cord. Always grasp the plug, not the cord. Never handle plug or appliance with wet hands.
- Store in a dry place. Do not expose machine to freezing temperatures.

Hercules Vapor Scrub Steam Cleaner

- This appliance can be used by children aged from 8 years and above and persons with reduced physical, sensory or mental capabilities or lack of experience and knowledge if they have been given supervision or instruction concerning use of the appliance in a safe way and understand the hazards involved. Children shall not play with the appliance. Cleaning and user maintenance shall not be made by children without supervision.
- The boiler becomes hot in use. Move only by using the carrying handle.
- Allow to cool completely before emptying boiler.
- Do not stand on boiler or hose.
- The equipment must be unplugged after use and before cleaning.



WARNING - Risk of injury

Caution! - Steam 100°C - Don't direct at people or animals

Cleaning Fabrics:

A number of materials and fabrics are NOT suitable to be cleaned by steam, for example: Do not use on leather, wax-polished furniture or floors, synthetic fabrics, velvet, Dralon or other delicate, steam-sensitive materials. All carpets and fabrics should be tested first before use.

Cleaning Glass/Mirrors:

Thermal shock can shatter glass. Before cleaning glass surfaces, carefully warm the surface by directing the steam jet on the glass from a distance no less than 6" (15cm).

How to put your Hercules Vapor Scrub Steam Cleaner together

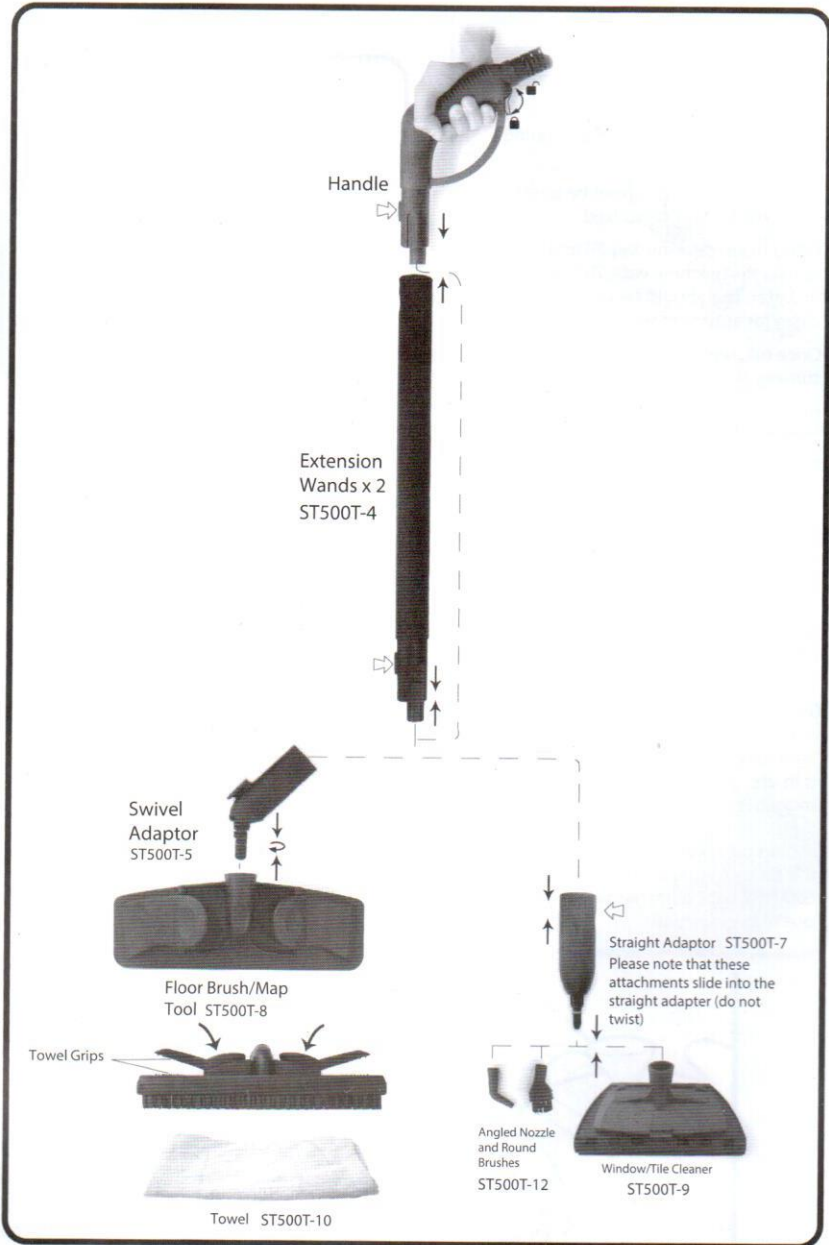

Hercules Vapor Scrub Steam Cleaner

Cleaning Floors

Instructions for Use

- Make sure the machine is unplugged from the electrical outlet.
- Unscrew the Safety Cap (2) by turning anti-clockwise.
Please note the cap cannot be unscrewed when the unit is pressurized.
- Using the measuring Jug (6) and Funnel (6a) fill the machine with 50 fl.oz (1500ml) of water. This should be sufficient to steam clean for approximately 45 minutes.
- Once full, replace the Safety Cap (2) by turning clockwise and fasten tightly.
- Attach the accessory or floor cleaning tool you require to the machine (see page 4).
- Now plug the machine into the electrical outlet and switch on. Two lights should illuminate. The RED light is a power indicator. The ORANGE light indicates that the machine is building steam pressure. When the machine is first turned on this light will illuminate. The machine takes up to 12 minutes to reach the correct pressure level depending on the amount of water in the tank.
- Once the ORANGE light has gone out the machine is ready to use. The ORANGE light may come back on when the machine is in use. If this happens, release the safety trigger at the Steam Gun (3) and allow the steam pressure to build up again. This should take no longer than 40 seconds. If the safety trigger is pressed when the ORANGE light is on, hot water may come out of the machine.

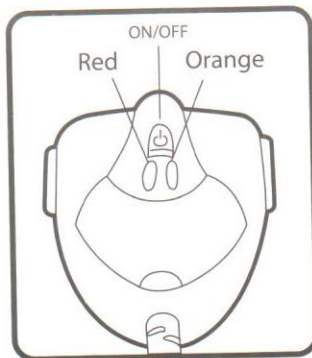
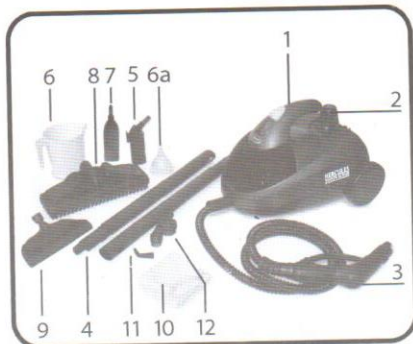
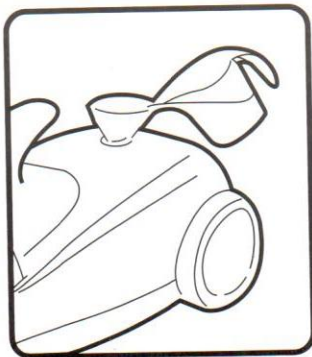

Refilling the water tank

- Switch the machine off using the ON/OFF button.
- Disconnect the power cable from the electrical outlet. Wait 5 minutes before squeezing the trigger to make sure the machine is no longer under pressure before unscrewing the Safety Cap (2). DO NOT unscrew the safety cap until the steam has stopped.
- Fill the water tank as necessary using the Funnel (6a) provided. DO NOT exceed 50 fl.oz (1500ml) of water. Replace the Safety Cap (2) by turning clockwise. Fasten cap tightly.
- You are now ready to switch the machine on and resume steam cleaning.

How to use the handle

- A. Press the button in to attach the Straight Adaptor (7) or the Extension Wands (4).
- B. Squeeze the trigger on the handle for steam.
- C. Lock the trigger for constant steam.

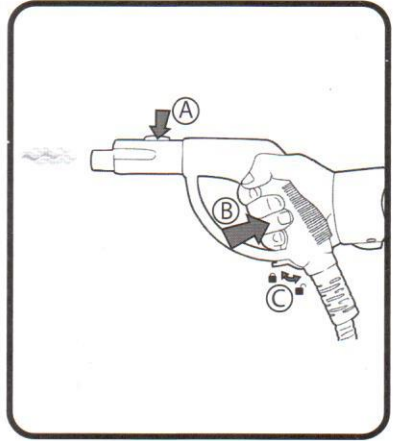

How to use the tools

- The Angled Nozzle (11) and the Brush Tools (12) can be used to get into awkward corners that are normally difficult to clean.
- Use the Brush Tools (12) to scrub and loosen stubborn dirt from hard surfaces.
- Use the Window/ Tile Cleaner (9) to clean grime from tiles and windows.
- To use these tools, first fit the Straight Adaptor (7). Depress the button on top of the handle and push the Straight Adaptor (7) on.
- Now you can push any of these three tools onto the tip of the jet-nozzle. Please note that these attachments slide onto the Straight Adaptor (7) (do not twist).

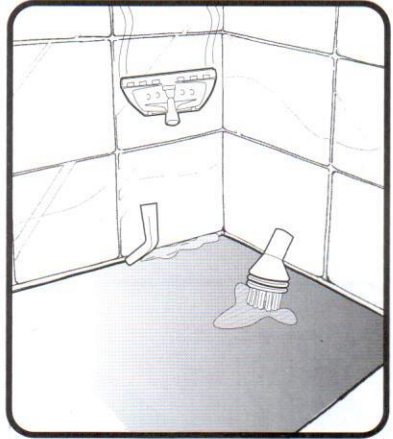

Hercules Vapor Scrub Steam Cleaner

- Attach the Floor Tool and Adaptor (8) to the Extension Wands (4), which snap together. Then attach Extension Wands (4) to the Steam Gun (3). Ensure the Extension Wands (4) are firmly connected.
- Before cleaning always remove dust from the surface you wish to clean.
- To release the Extension Wands (4) depress the button on the hose connection.

Cleaning floors & carpets with cleaning cloth.

- While the machine is switched off attach the Towel (10) to the Floor Tool (8) via the spring-loaded clips, Make sure the edges of the Towel (10) are secure. DO NOT attempt to do this while the machine is still hot.
- Never remove the Towel (10) while the safety trigger on the Steam Gun (3) is released or the machine is warm to the touch.



WARNING - Risk of injury!

Fitting the Accessories

- The accessories may be fitted to the Steam Gun (3) using Straight Adaptor (7). When fitting the Window/ Tile Cleaner (9), Straight Adaptor (7) is required.

When using the Round Brushes (12) or high-pressure nozzle, Straight Adaptor (7) is required.

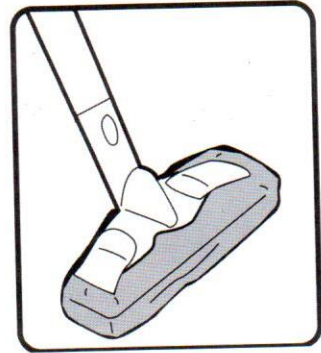
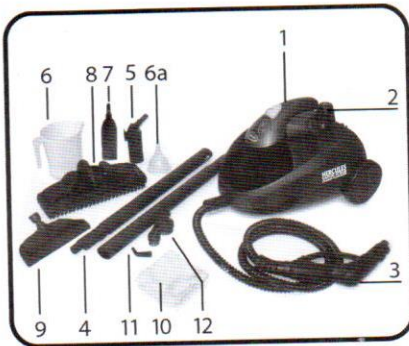

Cleaning and Maintenance

- Cleaning and maintenance operations should be carried out with the appliance disconnected from the power supply.
- The machine should be allowed to completely cool down before it is stored away or cleaned.
- Clean the machine and its accessories with a slightly damp cloth only.
- Never use a cleaning product or detergent.
- To ensure that your machine operates correctly over a long period, rinse out the water tank once a month to remove lime-scale deposits. White vinegar or a proprietary de-scaler solution can be used to clean inside the water tank.
- There are no customer service parts to the boiler unit, all repairs must be carried out by a qualified person.

Notes

Hercules Vapor Scrub Steam Cleaner

Technical data

- 8' power cord
- Water capacity - 50 fl.oz (1500ml)
- Steam-up time – up to 12 minutes depending on volume of water
- Working time – 45 minutes
- Tank material - Stainless Steel
- Voltage - 120V
- Frequency - 60Hz
- Power - 1500W

Troubleshooting

- **Water comes out of the Nozzle**
The Steam Cleaner creates a large amount of steam. This may condense as water or water droplets in the Steam Hose, tools and Nozzle are expelled when used after a period of cooling. This is normal and not a cause for concern.
- **Water flow is erratic; sometimes it works well, other times it does not**
If you have not used distilled or de-ionized water, you may have a small blockage inside your Steam Cleaner. Try descaling your unit.
Check all attachments are fitted correctly.
- **No Steam comes out**
Check that the hose has not become kinked or blocked. Also check the power supply and water level.
- **I cannot get the Steam Cap (2) off**
Make sure that you have fully de-pressurized the Boiler. See the section 'Refilling the water tank'.
- **I live in a hard water area, my Steam Cleaner does not work as well**
Empty the machine after use. In hard water areas your Steam Cleaner may benefit from occasional descaling. This can be done by using a kettle descaler solution. You can also use distilled or de-ionized water to extend the life of the product.

Your Warranty

This product is guaranteed for a period of 12 months against faulty materials and workman-ship. While every possible care is taken by Bissell BigGreen Commercial Products to ensure that our products leave the factory in good working order, Bissell BigGreen Commercial Products cannot under any circumstances accept liability for problems or damage caused by their subsequent use. It is the responsibility of the user to ensure the surfaces to be treated or cleaned are suitable for vacuuming. This warranty does not affect your statutory rights. This warranty excludes the use for rental. In the event of a fault occurring please contact our helpline before returning the unit to our Service Department at the address below together with a copy of your purchase receipt. All repairs will be dealt with speedily. Some States do not allow limitations on how long an implied warranty lasts and some States do not allow the exclusion or limitation of incidental or consequential damages, so part or all of the above limitations or exclusions may not apply to you. This warranty gives you specific legal rights, and you may also have other rights which vary from State to State.

For service and further information, please contact:
Bissell BigGreen Commercial 100 Armstrong Road, Suite 101, Plymouth, MA 02360
Phone: 800-242-1378 Fax: 877-672-4566
www.bissellcommercial.com

Made in China

Artwork EB0518 BGST500T UPC 811827020948